

LAKEVIEW PRAIRIE

A SUBDIVISION IN SECTION 34, TOWNSHIP 20 SOUTH, RANGE 67 WEST OF THE 6th P.M., PUEBLO COUNTY, COLORADO

- LEGEND**
- ALIQUOT MONUMENT AS NOTED
 - FOUND C.O.D.T. BRASS CAP IN CONCRETE MARKED AS INDICATED
 - SET 1/2" REBAR WITH 2.5" RED PLASTIC CAP BY COLO. PLS # 19683
 - SET 1/2" REBAR WITH 1" YELLOW PLASTIC CAP BY COLO. PLS # 19683
 - CALCULATED POSITION - NO MONUMENT FOUND OR SET
 - BOUNDARY LINE
 - LOT LINES
 - RIGHT-OF-WAY SIDELINE
 - ALIQUOT LINE
 - EXISTING OVERHEAD POWER LINES

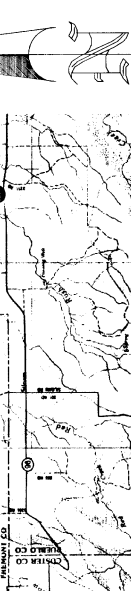
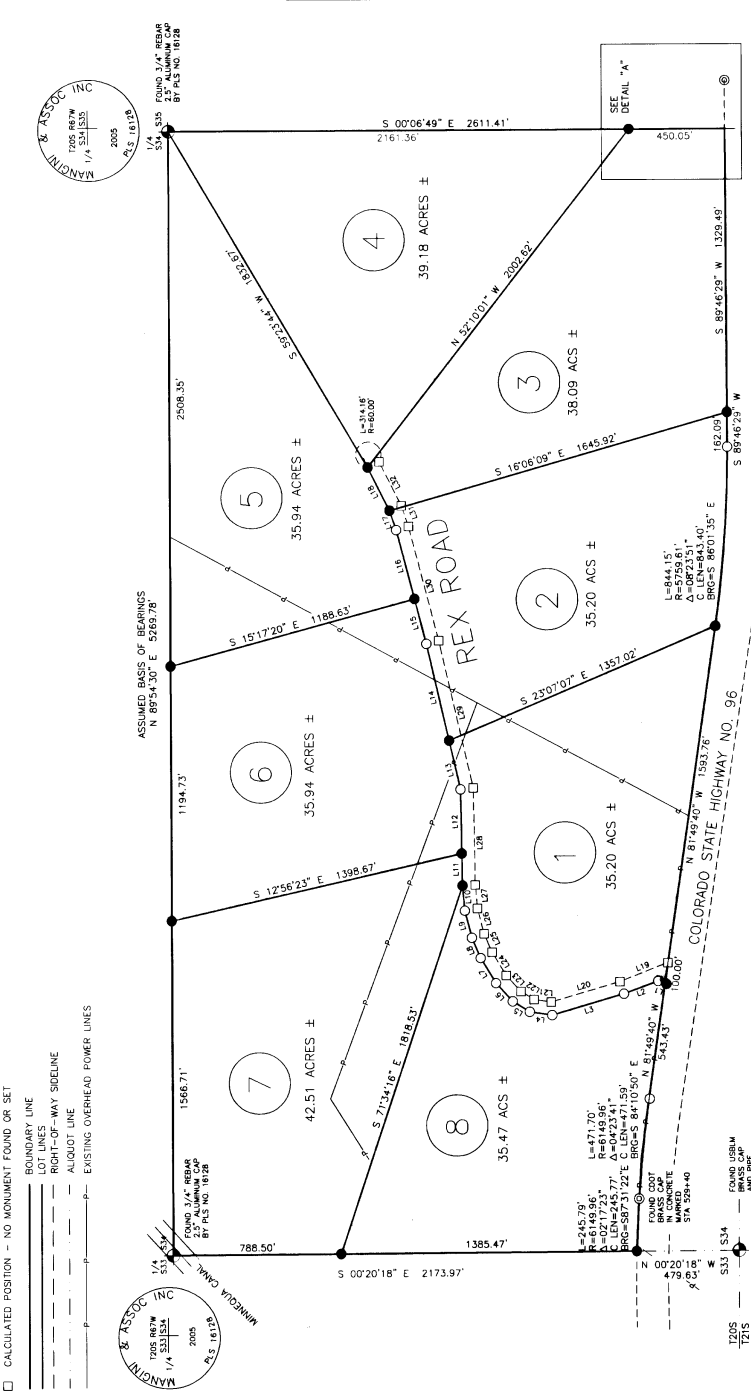
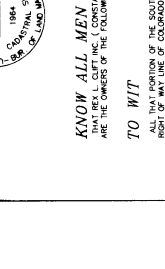
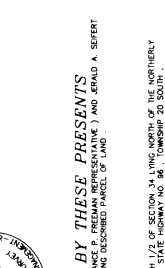
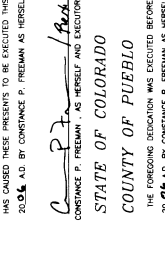
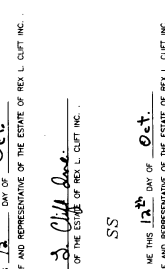
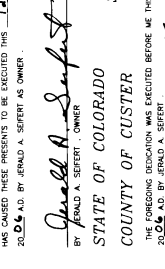
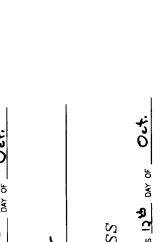
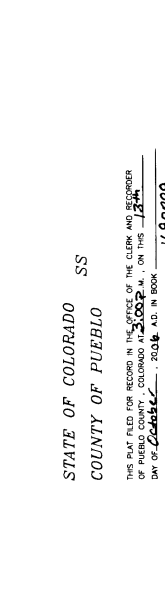
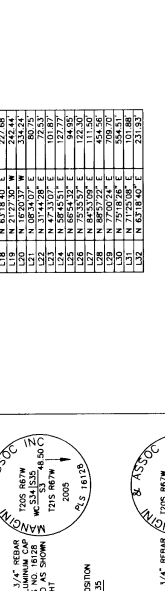
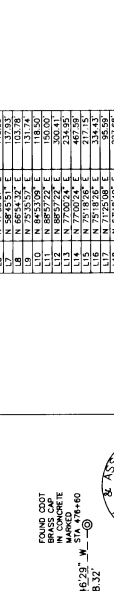
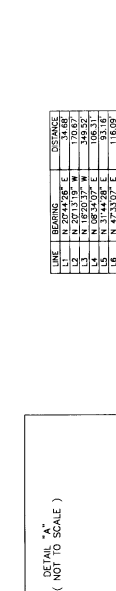

TABLE OF BEARINGS AND DISTANCES

LINE	BEARING	DISTANCE
L1	N 27°14'30" E	14.86
L2	N 18°20'30" W	24.52
L3	N 08°24'00" E	106.31
L4	N 47°11'00" E	116.09
L5	N 47°11'00" E	116.09
L6	N 28°45'30" E	133.76
L7	N 28°45'30" E	133.76
L8	N 28°45'30" E	133.76
L9	N 28°45'30" E	133.76
L10	N 28°45'30" E	133.76
L11	N 28°45'30" E	133.76
L12	N 28°45'30" E	133.76
L13	N 28°45'30" E	133.76
L14	N 28°45'30" E	133.76
L15	N 28°45'30" E	133.76
L16	N 28°45'30" E	133.76
L17	N 28°45'30" E	133.76
L18	N 28°45'30" E	133.76
L19	N 28°45'30" E	133.76
L20	N 28°45'30" E	133.76
L21	N 28°45'30" E	133.76
L22	N 28°45'30" E	133.76
L23	N 28°45'30" E	133.76
L24	N 28°45'30" E	133.76
L25	N 28°45'30" E	133.76
L26	N 28°45'30" E	133.76
L27	N 28°45'30" E	133.76
L28	N 28°45'30" E	133.76
L29	N 28°45'30" E	133.76
L30	N 28°45'30" E	133.76
L31	N 28°45'30" E	133.76
L32	N 28°45'30" E	133.76
L33	N 28°45'30" E	133.76
L34	N 28°45'30" E	133.76
L35	N 28°45'30" E	133.76
L36	N 28°45'30" E	133.76
L37	N 28°45'30" E	133.76
L38	N 28°45'30" E	133.76
L39	N 28°45'30" E	133.76
L40	N 28°45'30" E	133.76
L41	N 28°45'30" E	133.76
L42	N 28°45'30" E	133.76
L43	N 28°45'30" E	133.76
L44	N 28°45'30" E	133.76
L45	N 28°45'30" E	133.76
L46	N 28°45'30" E	133.76
L47	N 28°45'30" E	133.76
L48	N 28°45'30" E	133.76
L49	N 28°45'30" E	133.76
L50	N 28°45'30" E	133.76
L51	N 28°45'30" E	133.76
L52	N 28°45'30" E	133.76
L53	N 28°45'30" E	133.76
L54	N 28°45'30" E	133.76
L55	N 28°45'30" E	133.76
L56	N 28°45'30" E	133.76
L57	N 28°45'30" E	133.76
L58	N 28°45'30" E	133.76
L59	N 28°45'30" E	133.76
L60	N 28°45'30" E	133.76
L61	N 28°45'30" E	133.76
L62	N 28°45'30" E	133.76
L63	N 28°45'30" E	133.76
L64	N 28°45'30" E	133.76
L65	N 28°45'30" E	133.76
L66	N 28°45'30" E	133.76
L67	N 28°45'30" E	133.76
L68	N 28°45'30" E	133.76
L69	N 28°45'30" E	133.76
L70	N 28°45'30" E	133.76
L71	N 28°45'30" E	133.76
L72	N 28°45'30" E	133.76
L73	N 28°45'30" E	133.76
L74	N 28°45'30" E	133.76
L75	N 28°45'30" E	133.76
L76	N 28°45'30" E	133.76
L77	N 28°45'30" E	133.76
L78	N 28°45'30" E	133.76
L79	N 28°45'30" E	133.76
L80	N 28°45'30" E	133.76
L81	N 28°45'30" E	133.76
L82	N 28°45'30" E	133.76
L83	N 28°45'30" E	133.76
L84	N 28°45'30" E	133.76
L85	N 28°45'30" E	133.76
L86	N 28°45'30" E	133.76
L87	N 28°45'30" E	133.76
L88	N 28°45'30" E	133.76
L89	N 28°45'30" E	133.76
L90	N 28°45'30" E	133.76
L91	N 28°45'30" E	133.76
L92	N 28°45'30" E	133.76
L93	N 28°45'30" E	133.76
L94	N 28°45'30" E	133.76
L95	N 28°45'30" E	133.76
L96	N 28°45'30" E	133.76
L97	N 28°45'30" E	133.76
L98	N 28°45'30" E	133.76
L99	N 28°45'30" E	133.76
L100	N 28°45'30" E	133.76



IN WITNESS WHEREOF
 I, JERALD A. SEBERT, OWNER
 HAS CAUSED THESE PRESENTS TO BE EXECUTED THIS 12th DAY OF Oct.
 2006 A.D. BY CONSTANCE P. FREEMAN AND REPRESENTATIVE OF THE ESTATE OF REX L. CLIFT INC.,

IN WITNESS WHEREOF
 REX L. CLIFT INC.
 HAS CAUSED THESE PRESENTS TO BE EXECUTED THIS 12th DAY OF Oct.
 2006 A.D. BY CONSTANCE P. FREEMAN AND REPRESENTATIVE OF THE ESTATE OF REX L. CLIFT INC.,

IN WITNESS WHEREOF
 I, JERALD A. SEBERT, OWNER
 HAS CAUSED THESE PRESENTS TO BE EXECUTED THIS 12th DAY OF Oct.
 2006 A.D. BY CONSTANCE P. FREEMAN AND REPRESENTATIVE OF THE ESTATE OF REX L. CLIFT INC.,

KNOW ALL MEN BY THESE PRESENTS
 THAT THE UNDERSIGNED AS OWNERS HAVE CAUSED THE PARCEL SHOWN AND DESCRIBED ON THIS SHEET TO BE SURVEYED AND SUBDIVIDED INTO LOTS AND ALIQUOTS AS SHOWN, DESCRIBED AND DEFINED AND BOUND ON THIS SHEET. ALL TO BE KNOWN AS LAKEVIEW PRAIRIE.

TO WIT
 ALL THAT PORTION OF THE SOUTH 1/2 OF SECTION 34 LYING NORTH OF THE NORTHERLY RIGHT-OF-WAY LINE OF COLORADO STATE HIGHWAY NO. 96, AND THE SOUTHWEST 1/4 OF SECTION 34, TOWNSHIP 20 SOUTH, RANGE 67 WEST OF THE 6TH P.M., PUEBLO COUNTY, COLORADO.

DEDICATION
 THE UNDERSIGNED AS OWNERS HAVE CAUSED THE PARCEL SHOWN AND DESCRIBED ON THIS SHEET TO BE SURVEYED AND SUBDIVIDED INTO LOTS AND ALIQUOTS AS SHOWN, DESCRIBED AND DEFINED AND BOUND ON THIS SHEET. ALL TO BE KNOWN AS LAKEVIEW PRAIRIE.

EASEMENT DEFINITIONS
 REX ROAD (AS SHOWN) IS HEREBY SET ASIDE AS AN EASEMENT FOR INGRESS, EGRESS AND THE INSTALLATION AND MAINTENANCE OF UTILITIES FOR THE USE AND BENEFIT OF ALL LAKEVIEW PRAIRIE LOT OWNERS.

NOTES
 1. THIS LAND SURVEY PLAT DOES NOT CONSTITUTE A TITLE SEARCH BY SHY SURVEYORS AND ASSOCIATES, INC. FOR ANY UNRECORDED INTERESTS OR ENCUMBRANCES OF RECORD. ANY DEFECTS IN THIS SURVEY WITHIN THREE YEARS OF THE DATE OF RECORDING, SHALL BE THE RESPONSIBILITY OF THE SURVEYORS. ANY DEFECTS IN THIS SURVEY WITHIN THREE YEARS OF THE DATE OF RECORDING, SHALL BE THE RESPONSIBILITY OF THE SURVEYORS. SURVEYORS RELEASING THIS PLAT UNDER A WRIT OF HABEAS CORPUS SHALL BE DEEMED TO HAVE RELEASED THE SURVEY FROM ALL LIABILITY FOR DEFECTS IN THIS SURVEY.

NOTES
 1. THIS LAND SURVEY PLAT DOES NOT CONSTITUTE A TITLE SEARCH BY SHY SURVEYORS AND ASSOCIATES, INC. FOR ANY UNRECORDED INTERESTS OR ENCUMBRANCES OF RECORD. ANY DEFECTS IN THIS SURVEY WITHIN THREE YEARS OF THE DATE OF RECORDING, SHALL BE THE RESPONSIBILITY OF THE SURVEYORS. ANY DEFECTS IN THIS SURVEY WITHIN THREE YEARS OF THE DATE OF RECORDING, SHALL BE THE RESPONSIBILITY OF THE SURVEYORS. SURVEYORS RELEASING THIS PLAT UNDER A WRIT OF HABEAS CORPUS SHALL BE DEEMED TO HAVE RELEASED THE SURVEY FROM ALL LIABILITY FOR DEFECTS IN THIS SURVEY.

NOTES
 1. THIS LAND SURVEY PLAT DOES NOT CONSTITUTE A TITLE SEARCH BY SHY SURVEYORS AND ASSOCIATES, INC. FOR ANY UNRECORDED INTERESTS OR ENCUMBRANCES OF RECORD. ANY DEFECTS IN THIS SURVEY WITHIN THREE YEARS OF THE DATE OF RECORDING, SHALL BE THE RESPONSIBILITY OF THE SURVEYORS. ANY DEFECTS IN THIS SURVEY WITHIN THREE YEARS OF THE DATE OF RECORDING, SHALL BE THE RESPONSIBILITY OF THE SURVEYORS. SURVEYORS RELEASING THIS PLAT UNDER A WRIT OF HABEAS CORPUS SHALL BE DEEMED TO HAVE RELEASED THE SURVEY FROM ALL LIABILITY FOR DEFECTS IN THIS SURVEY.

NOTES
 1. THIS LAND SURVEY PLAT DOES NOT CONSTITUTE A TITLE SEARCH BY SHY SURVEYORS AND ASSOCIATES, INC. FOR ANY UNRECORDED INTERESTS OR ENCUMBRANCES OF RECORD. ANY DEFECTS IN THIS SURVEY WITHIN THREE YEARS OF THE DATE OF RECORDING, SHALL BE THE RESPONSIBILITY OF THE SURVEYORS. ANY DEFECTS IN THIS SURVEY WITHIN THREE YEARS OF THE DATE OF RECORDING, SHALL BE THE RESPONSIBILITY OF THE SURVEYORS. SURVEYORS RELEASING THIS PLAT UNDER A WRIT OF HABEAS CORPUS SHALL BE DEEMED TO HAVE RELEASED THE SURVEY FROM ALL LIABILITY FOR DEFECTS IN THIS SURVEY.

STATE OF COLORADO
COUNTY OF PUEBLO
 SS
 THIS PLAT FILED FOR RECORD IN THE OFFICES OF THE CLERK AND RECORDER OF THE COUNTY OF PUEBLO, COLORADO, ON THIS 12th DAY OF October, 2006 A.D. IN BOOK 1697799 UNDER RECEPTION NUMBER 1697799 AT PAGE _____

By: Ronald A. Sebert
 TITLE: Recording Clerk

By: Jerald A. Sebert
 TITLE: Owner

By: Constance P. Freeman
 TITLE: Representative of the Estate of Rex L. Clift Inc.

By: Kent Beach
 TITLE: Surveyor

STATE OF COLORADO
COUNTY OF PUEBLO
 SS
 THE FOREGOING DEDICATION WAS EXECUTED BEFORE ME THIS 12th DAY OF Oct.
 2006 A.D. BY CONSTANCE P. FREEMAN AND REPRESENTATIVE OF THE ESTATE OF REX L. CLIFT INC.,
 WITNESS MY HAND AND SEAL 9/19/07
 MY COMMISSION EXPIRES _____

STATE OF COLORADO
COUNTY OF PUEBLO
 SS
 THE FOREGOING DEDICATION WAS EXECUTED BEFORE ME THIS 12th DAY OF Oct.
 2006 A.D. BY CONSTANCE P. FREEMAN AND REPRESENTATIVE OF THE ESTATE OF REX L. CLIFT INC.,
 WITNESS MY HAND AND SEAL 9/19/07
 MY COMMISSION EXPIRES _____

STATE OF COLORADO
COUNTY OF PUEBLO
 SS
 THE FOREGOING DEDICATION WAS EXECUTED BEFORE ME THIS 12th DAY OF Oct.
 2006 A.D. BY CONSTANCE P. FREEMAN AND REPRESENTATIVE OF THE ESTATE OF REX L. CLIFT INC.,
 WITNESS MY HAND AND SEAL 9/19/07
 MY COMMISSION EXPIRES _____

STATE OF COLORADO
COUNTY OF PUEBLO
 SS
 THE FOREGOING DEDICATION WAS EXECUTED BEFORE ME THIS 12th DAY OF Oct.
 2006 A.D. BY CONSTANCE P. FREEMAN AND REPRESENTATIVE OF THE ESTATE OF REX L. CLIFT INC.,
 WITNESS MY HAND AND SEAL 9/19/07
 MY COMMISSION EXPIRES _____

STATE OF COLORADO
COUNTY OF PUEBLO
 SS
 THE FOREGOING DEDICATION WAS EXECUTED BEFORE ME THIS 12th DAY OF Oct.
 2006 A.D. BY CONSTANCE P. FREEMAN AND REPRESENTATIVE OF THE ESTATE OF REX L. CLIFT INC.,
 WITNESS MY HAND AND SEAL 9/19/07
 MY COMMISSION EXPIRES _____

Shy Surveyors & Assoc.
 500 HERMIT ROAD, P.O. BOX 1280, WESTCLIFFE, COLORADO 81252
 Phone (719) 788-2847 Fax (719) 788-2310
 DMC FILE # 1697799-11-000
 PA # 159 SERIALIZED 11-000
 CHECKED BY ADD 09/26/06
 CEF/DEPOSIT DATE _____
 JOB NUMBER _____
 DRAWER NUMBER _____

1697799
 1913-2006 03 RRP
 11/11/07
 0311 E. Ross Manufacturing Drive, P.O. Box 111, Avon, CO 81611

1697799
 1913-2006 03 RRP
 11/11/07
 0311 E. Ross Manufacturing Drive, P.O. Box 111, Avon, CO 81611

1697799
 1913-2006 03 RRP
 11/11/07
 0311 E. Ross Manufacturing Drive, P.O. Box 111, Avon, CO 81611

1697799
 1913-2006 03 RRP
 11/11/07
 0311 E. Ross Manufacturing Drive, P.O. Box 111, Avon, CO 81611